



REPUBLIC OF BULGARIA
MINISTRY OF LABOUR AND SOCIAL POLICY



The European confederation of
cooperatives and worker-owned enterprises
active in industry and services



AGENCY FOR
DISABLED PEOPLE



International Fair Plovdiv, Bulgaria



EUROPEAN FORUM

FIFTH EUROPEAN FAIR OF ENTERPRISES AND COOPERATIVES IN SOCIAL ECONOMY

31 March – 3 April 2016
Plovdiv, BULGARIA

USEFUL INFORMATION

VENUE

International Fair in Plovdiv
37, Tzar Boris III Obedinitel Blvd.
4003, Plovdiv, BULGARIA
Fax: (+359) 32/902 432
www.fair.bg
fairinfo@fair.bg

THE OPENING TIMES OF THE FAIR – 9:00–18:00

RESTAURANTS

- ❖ At the Fairground
 - Fontana Café-Restaurant (Pavilion 9A)
 - Café (Pavilion 7)
- ❖ At the Old Town – Puldin Restaurant Complex
3, Knyaz Tseretelev Str.,
tel.: +359 32/631 720, 624 510

WIFI – the lobby of International Fair Plovdiv

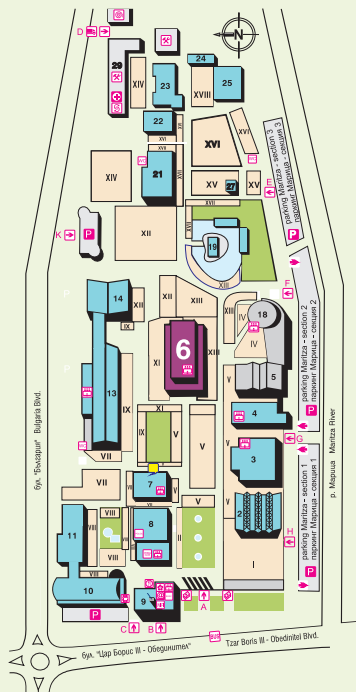

ACCOMMODATION

Park-hotel "Sankt Peterburg" 4****

www.sphotel.net

The hotel is approximately 1 km away from the Fair. Transportation to the Fair and back has been provided, which is included in the accommodation price:

Price per single studio	41 Euros
Price per double studio	60 Euros
Price per single room	30 Euros
Price per apartment	100 Euros
Parking	3 Euros

Prices include accommodation, breakfast, tourist tax, insurance and VAT.

ARRIVAL BY PLANE (SOFIA) AND TRANSPORTS TO PLOVDIV

Sofia Airport - www.sofia-airport.bg

You can travel from Sofia to Plovdiv by railway or by bus.

You have to go to the Central Railway Station, or to the Central Bus Station (located in close proximity).

From Sofia Airport (Terminal I and II) to the Central Railway Station and the Central Bus Station in Sofia, you should follow following route:

From the Airport to the stop "Hospital St. Ana", you should travel on bus 84. At the same stop, you should take the bus 305 until the stop "Centralna Gara" (Central Railway Station). The ticket price for the public transport is 1 Lev.

Central Railway Station Sofia – for more information www.bdz.bg

From the Central Railway Station Sofia, there are trains to Plovdiv from 06:55 to 22:40.

The distance from Sofia to Plovdiv will take 2 hours and a half.

The ticket price is approximately 10 Leva.

From the Railway Station Plovdiv to the Fair you should take bus 7.

Central Bus Station Sofia - www.centralnaavtogara.bg

From the Central Bus Station Sofia, buses depart to Plovdiv every hour from 07:00 to 20:00.

The distance from the Central Bus Station Sofia to bus station „Yug" (South) in Plovdiv, is approximately two hours by bus.

The ticket price is 14 Leva.

From the bus station to the Fair you should take bus 7.

CURRENCY

The official currency is Bulgarian Lev.

Fixed exchange rate: 1 Euro = 1.95583 Leva

For more information please contact:

National Union of Worker Producers' Cooperatives

Tel. +359 2/987 11 95

e-mail: uniontpk@uniontpk.com



The European Fair of Enterprises and Cooperatives in Social Economy will be held for the fifth time in a row in 2016 at the Fairgrounds of International Fair Plovdiv.

The event was launched in 2003, the European Year of People with Disabilities.

Since 2012, the exhibition has developed into an international event - a European forum comprising an international conference, a roundtable discussion and a European Fair.

The holding of the forum was possible thanks to the support of the Ministry of Labour and Social Policy of Bulgaria, International Fair Plovdiv and the European Commission, which is the co-organizer of the event, has its own exhibition stand at the fair and is an active participant in the conferences and roundtable discussions as well.

Such forums, organized in the countries of the European Union, are unique events in view of their nature and objectives.

International Fair Plovdiv, the largest exhibition centre in Southeastern Europe, has been hosting these events in one of the most impressive pavilions at the Fairgrounds. The occupied exhibition area is about 1,000 sq.m.

In 2015, participants in the European Fair were about 100 social enterprises and cooperatives from Belgium, Bulgaria, Italy, Romania, Spain and Turkey, and the number of visitors amounted to 30, 000.

The exhibitors showed products, household articles and services within the scope of business activities of the enterprises, including small antique objects, wooden articles and products for people with hearing and speech impairment, etc.

Considerable exhibition space is also devoted to the services intended for people with disabilities.

All expenses relating to the exhibition stand design, stand decoration, arrangement, inscriptions, printing and distribution of advertising catalogues in Bulgarian and English, as well as TV promotion shall be covered by the organizers.

International Fair Plovdiv provides an excellent exhibition venue and opens up opportunities for establishing new business contacts and partnerships.